

DUPLEX 'B' LOT GRADING TEMPLATE

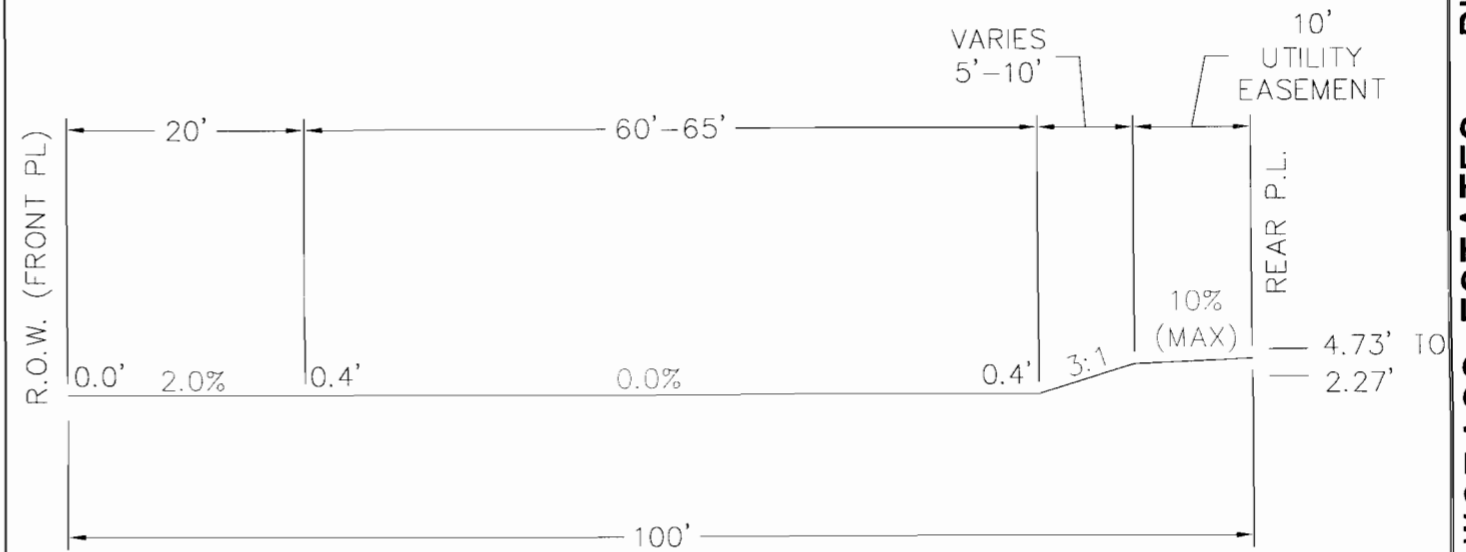

'A' LOT GRADING TEMPLATE

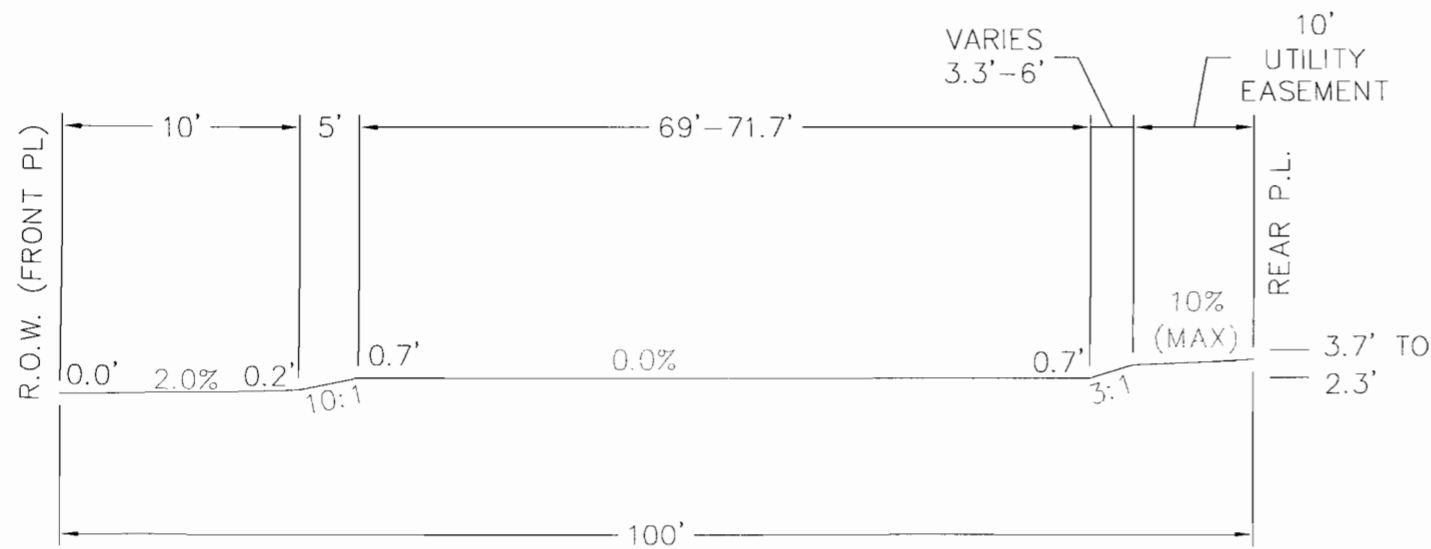

DUPLEX 'A' LOT GRADING TEMPLATE

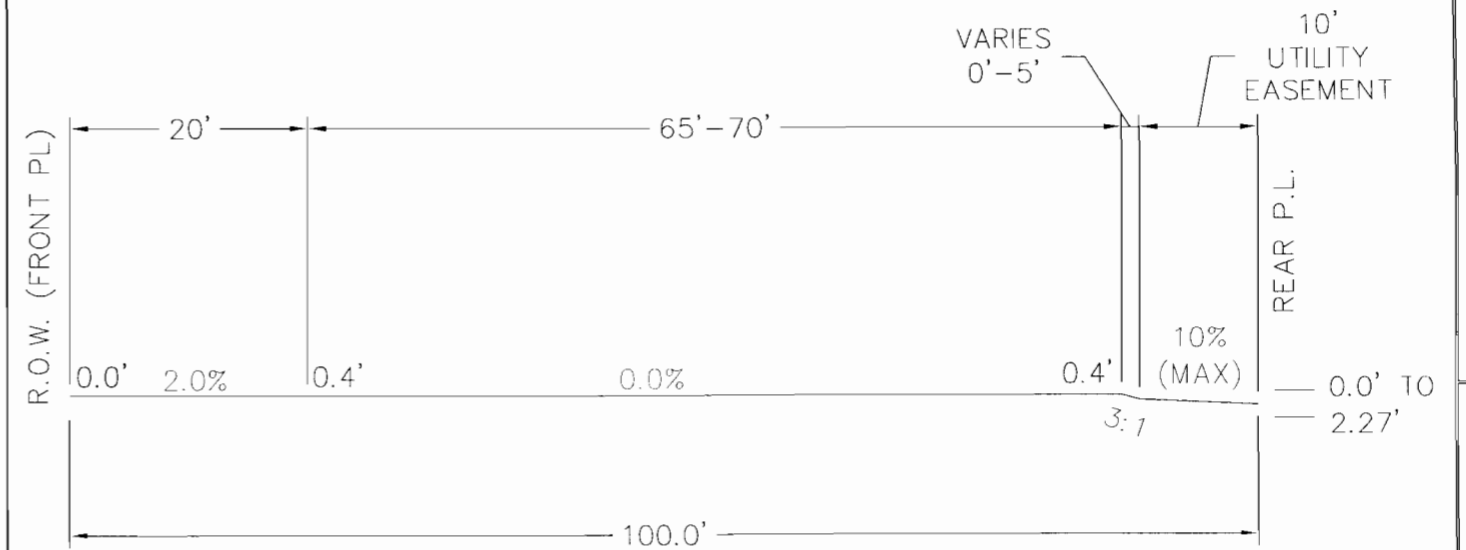

'B' LOWERED REAR LOT GRADING TEMPLATE

SAWGRASS ESTATES - PHASE 1  
OVERALL  
OVERLOT GRADING PLAN

PREPARED FOR: IGC MANAGEMENT INC. DATE SUBMITTED: 03/09/07

**NOBLE**

BEYOND ENGINEERING  
FORT COLLINS, CO 80526  
WWW.NOBLE.COM  
1901 BHARD POINT DRIVE, SUITE A  
970.221.1400 TEL 970.221.1415 FAX

NO.	BY	DATE	REVISIONS:
1	JCB	5/7/07	ADDRESS COMMENTS

SHEET NUMBER  
**OV02**  
OF 88 SHEETS  
JOB NUMBER  
FCB0215

XREFS: EXIST. FINISH ELEVATIONS

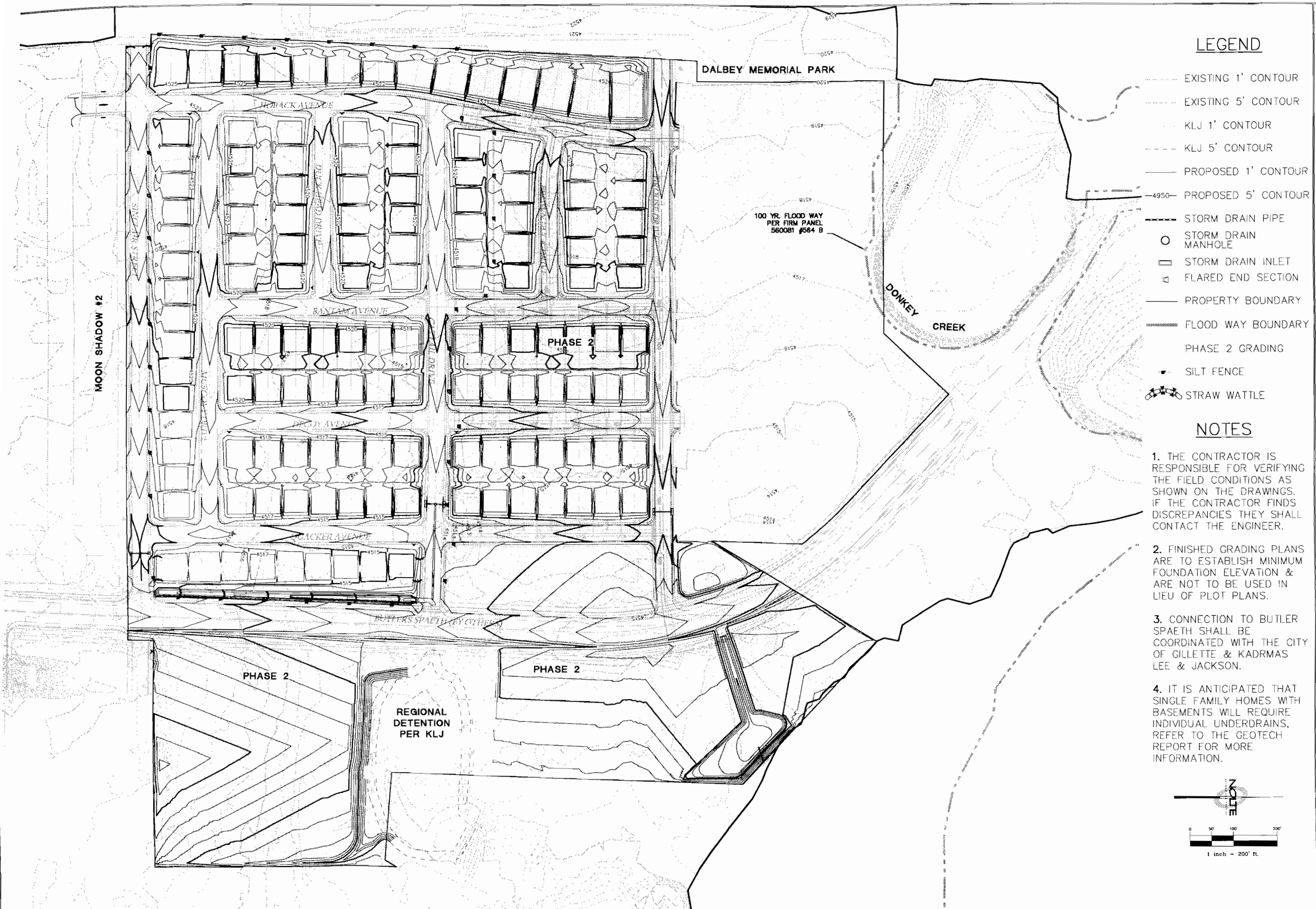

**LEGEND**

- EXISTING 1' CONTOUR
- EXISTING 5' CONTOUR
- KLJ 1' CONTOUR
- KLJ 5' CONTOUR
- PROPOSED 1' CONTOUR
- PROPOSED 5' CONTOUR
- STORM DRAIN PIPE
- STORM DRAIN MANHOLE
- STORM DRAIN INLET
- △ FLARED END SECTION
- PROPERTY BOUNDARY
- FLOOD WAY BOUNDARY
- PHASE 2 GRADING
- SILT FENCE
- STRAW WATTLE

**NOTES**

1. THE CONTRACTOR IS RESPONSIBLE FOR VERIFYING THE FIELD CONDITIONS AS SHOWN ON THE DRAWINGS. IF THE CONTRACTOR FINDS DISCREPANCIES THEY SHALL CONTACT THE ENGINEER.
2. FINISHED GRADING PLANS ARE TO ESTABLISH MINIMUM FOUNDATION ELEVATION & ARE NOT TO BE USED IN LIEU OF PLOT PLANS.
3. CONNECTION TO BUTLER SPAETH SHALL BE COORDINATED WITH THE CITY OF GILLETTE & KADRMAS LEE & JACKSON.
4. IT IS ANTICIPATED THAT SINGLE FAMILY HOMES WITH BASEMENTS WILL REQUIRE INDIVIDUAL UNDERDRAINS, REFER TO THE GEOTECH REPORT FOR MORE INFORMATION.

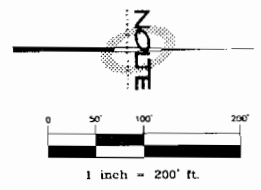

**SAWGRASS ESTATES - PHASE 1**  
**OVERALL**  
**FINISHED GRADING & EROSION CONTROL PLAN**  
 PREPARED FOR: IGC MANAGEMENT INC. DATE SUBMITTED: 03/09/07

**NOTICE**  
 BEYOND ENGINEERING  
 FORT COLLINS, CO 80526  
 WWW.BOEING.COM  
 1901 SHARP POINT DRIVE, SUITE A  
 970.221.2400 TEL. 970.221.2416 FAX

NO.	BY	DATE	REVISIONS:
1.	JCB	5/7/07	ADDRESS COMMENTS

SHEET NUMBER  
**GR01**  
 OF 88 SHEETS  
 JOB NUMBER  
**FCB0215**

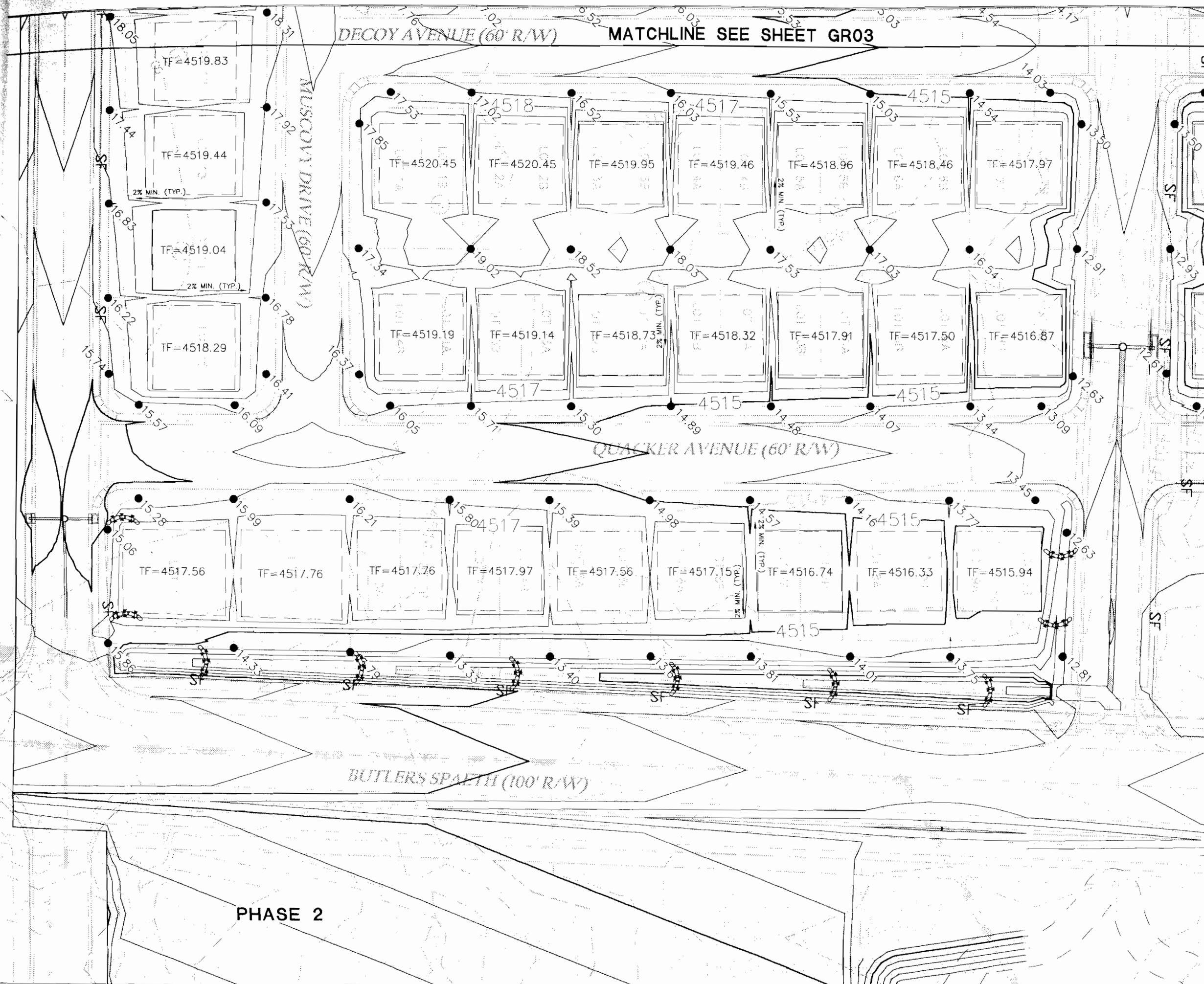

- LEGEND**
- EXISTING 1' CONTOUR
  - EXISTING 5' CONTOUR
  - - - - - KLJ 1' CONTOUR
  - - - - - KLJ 5' CONTOUR
  - PROPOSED 1' CONTOUR
  - - - - - PROPOSED 5' CONTOUR
  - STORM DRAIN PIPE
  - STORM DRAIN MANHOLE
  - △ STORM DRAIN INLET
  - ▴ FLARED END SECTION
  - PROPERTY BOUNDARY
  - FLOOD WAY BOUNDARY
  - PHASE 2 GRADING
  - SF SILT FENCE
  - STRAW WATTLE
  - SPOT ELEVATION
- NOTES**
1. THE CONTRACTOR IS RESPONSIBLE FOR VERIFYING THE FIELD CONDITIONS AS SHOWN ON THE DRAWINGS. IF THE CONTRACTOR FINDS DISCREPANCIES THEY SHALL CONTACT THE ENGINEER.
  2. FINISHED GRADING PLANS ARE TO ESTABLISH MINIMUM FOUNDATION ELEVATION & ARE NOT TO BE USED IN LIEU OF PLOT PLANS.
  3. CONNECTION TO BUTLER SPAETH SHALL BE COORDINATED WITH THE CITY OF GILLETTE & KADRMAS LEE & JACKSON.
  4. ELEVATION ARE 45XX.XX UNLESS OTHERWISE NOTED.
  5. IT IS ANTICIPATED THAT SINGLE FAMILY HOMES WITH BASEMENTS WILL REQUIRE INDIVIDUAL UNDERDRAINS, REFER TO THE GEOTECH REPORT FOR MORE INFORMATION.

**SAWGRASS ESTATES - PHASE 1**  
**FINISHED GRADING & EROSION CONTROL PLAN**

**NOTE**  
 BEYOND ENGINEERING

NO.	BY	DATE	REVISIONS:
1.	JOB	5/7/07	ADDRESS COMMENTS

SHEET NUMBER  
**GR02**  
 OF 88 SHEETS  
 JOB NUMBER  
 FCB0215

PREPARED FOR: IGC MANAGEMENT INC. DATE SUBMITTED: 03/09/07

1901 SHARP POINT DRIVE, SUITE A  
 FORT COLLINS, CO 80525  
 970.2212400 TEL. 970.2212415 FAX  
 WWW.MOLECOM

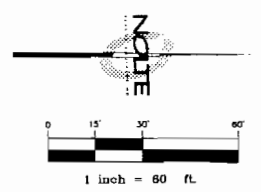

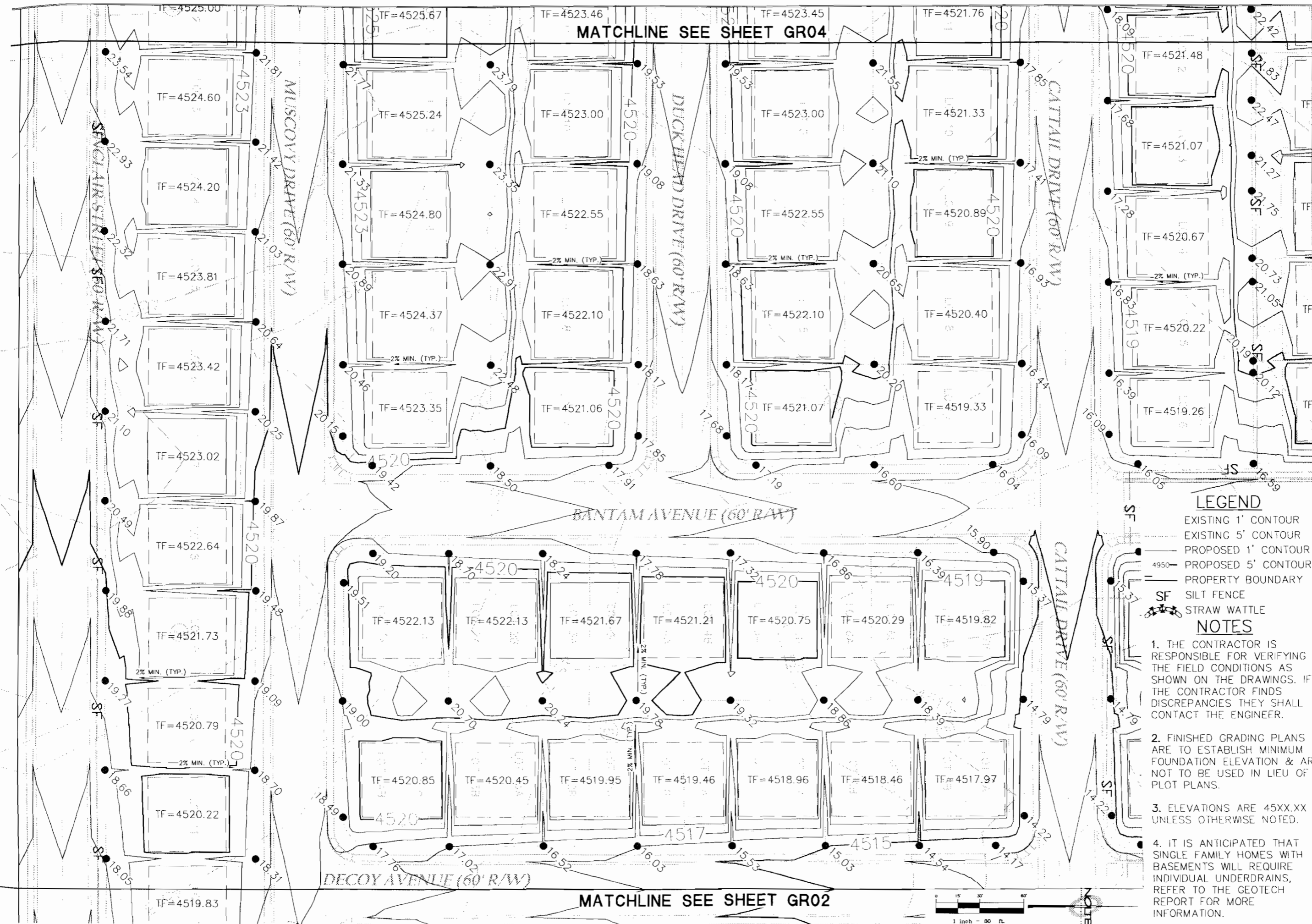

MATCHLINE SEE SHEET GR04

MATCHLINE SEE SHEET GR02

**LEGEND**

- EXISTING 1' CONTOUR
- EXISTING 5' CONTOUR
- PROPOSED 1' CONTOUR
- PROPOSED 5' CONTOUR
- PROPERTY BOUNDARY
- SF SILT FENCE
- STRAW WATTLE

**NOTES**

1. THE CONTRACTOR IS RESPONSIBLE FOR VERIFYING THE FIELD CONDITIONS AS SHOWN ON THE DRAWINGS. IF THE CONTRACTOR FINDS DISCREPANCIES THEY SHALL CONTACT THE ENGINEER.
2. FINISHED GRADING PLANS ARE TO ESTABLISH MINIMUM FOUNDATION ELEVATION & ARE NOT TO BE USED IN LIEU OF PLOT PLANS.
3. ELEVATIONS ARE 45XX.XX UNLESS OTHERWISE NOTED.
4. IT IS ANTICIPATED THAT SINGLE FAMILY HOMES WITH BASEMENTS WILL REQUIRE INDIVIDUAL UNDERDRAINS, REFER TO THE GEOTECH REPORT FOR MORE INFORMATION.

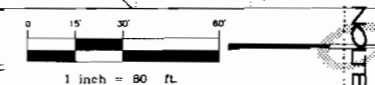

**SAWGRASS ESTATES - PHASE 1**

**FINISHED GRADING & EROSION CONTROL PLAN**

PREPARED FOR: IGC MANAGEMENT INC. DATE SUBMITTED: 03/09/07

**NOTE**

BEYOND ENGINEERING  
 FORT COLLINS, CO 80526  
 WWW.BOLTECOM  
 1901 SHARP POINT DRIVE, SUITE A  
 FORT COLLINS, CO 80526  
 970.2212400 TEL. 970.2212416 FAX

NO.	BY	DATE	REVISIONS:
1	JCB	5/7/07	ADDRESS COMMENTS

SHEET NUMBER  
**GR03**  
 OF 88 SHEETS  
 JOB NUMBER  
 FC0215



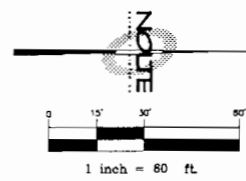

**LEGEND**

- EXISTING 1' CONTOUR
- EXISTING 5' CONTOUR
- PROPOSED 1' CONTOUR
- 4950- PROPOSED 5' CONTOUR
- PROPERTY BOUNDARY
- SF- SILT FENCE
- STRAW WATTLE

**NOTES**

1. THE CONTRACTOR IS RESPONSIBLE FOR VERIFYING THE FIELD CONDITIONS AS SHOWN ON THE DRAWINGS. IF THE CONTRACTOR FINDS DISCREPANCIES THEY SHALL CONTACT THE ENGINEER.
2. FINISHED GRADING PLANS ARE TO ESTABLISH MINIMUM FOUNDATION ELEVATION & ARE NOT TO BE USED IN LIEU OF PLOT PLANS.
3. ELEVATIONS ARE 45XX.XX UNLESS OTHERWISE NOTED.
4. IT IS ANTICIPATED THAT SINGLE FAMILY HOMES WITH BASEMENTS WILL REQUIRE INDIVIDUAL UNDERDRAINS, REFER TO THE GEOTECH REPORT FOR MORE INFORMATION.

**DALBEY MEMORIAL PARK**

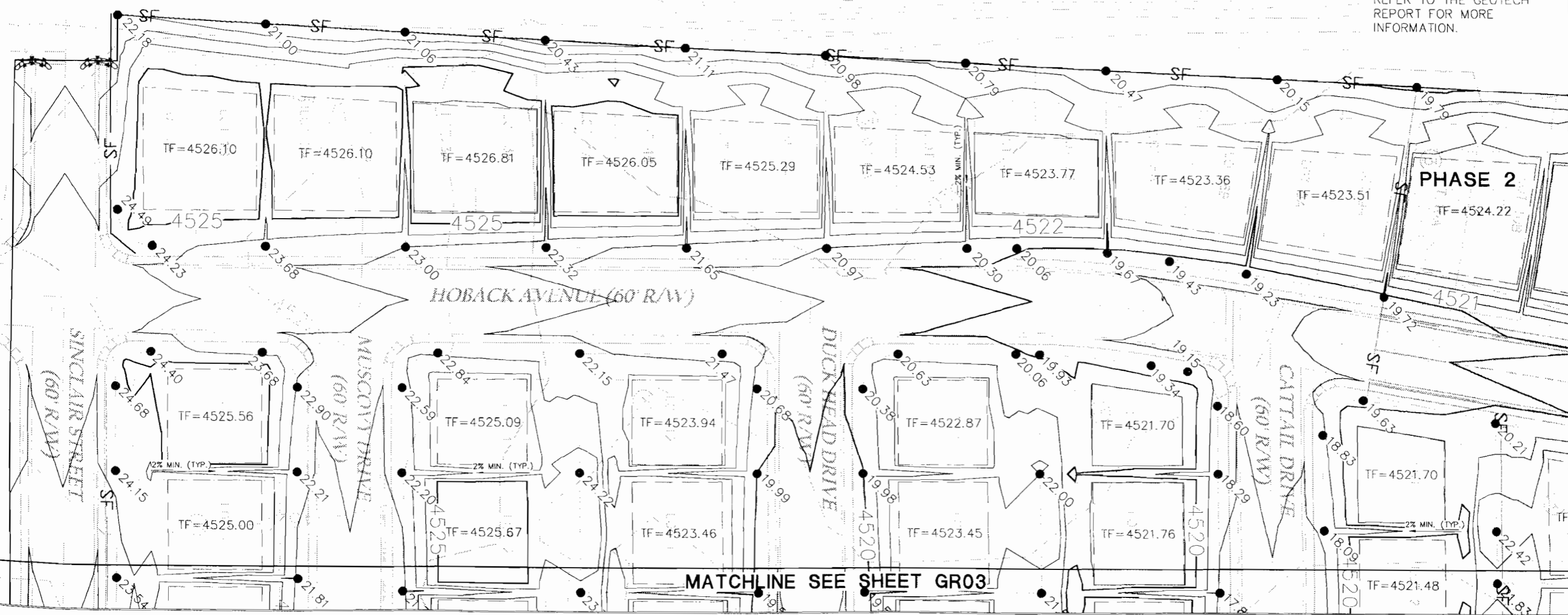

MATCHLINE SEE SHEET GR03

**SAWGRASS ESTATES - PHASE 1**

**FINISHED GRADING & EROSION CONTROL PLAN**

PREPARED FOR: IGC MANAGEMENT INC. DATE SUBMITTED: 03/09/07

**NOTICE**

BEYOND ENGINEERING  
FORT COLLINS, CO 80526  
WWW.BOLTECOM

NO.	BY	DATE	REVISIONS:	
			DATE	ADDRESS COMMENTS
1.	JCB	5/7/07		

SHEET NUMBER  
**GR04**

OF 88 SHEETS  
JOB NUMBER  
FCB0215